

VAN RONKLE STREET BOX CULVERT IMPROVEMENTS CONWAY, ARKANSAS CONSTRUCTION PACKAGE

REVISIONS

| NO. | DESCRIPTION | DATE |
|-----|-------------|------|
| | | |
| | | |
| | | |

VICINITY MAP

INDEX TO DRAWINGS



- C0 COVER SHEET
- C1 BOX CULVERT PLAN & DETAILS

VAN RONKLE STREET
 BOX CULVERT IMPROVEMENTS

N.T.S

JOB NUMBER: 17-111
 DRAWN BY: NTR
 CHECKED BY: BFV3
 DATE: 7/19/19
 SCALE: 1"=10'

DATE: JULY 19, 2018
 JOB#: 17-111

CONWAY TRANSPORTATION DEPARTMENT
 100 E. ROBINS STREET STREET CONWAY, ARKANSAS
 PH: 501.450.6165 FAX: 501.513.3566

COVER

C0

REVISIONS

| NO. | DESCRIPTION | DATE |
|-----|-------------|------|
| | | |
| | | |
| | | |

VAN RONKLE STREET
BOX CULVERT & ROADWAY

JOB NUMBER: 17-111

DRAWN BY: NTR

CHECKED BY: BFV3

DATE: 7/19/2019

SCALE: 1" = 10'

VAN RONKLE ST.
BOX CULVERT

C1

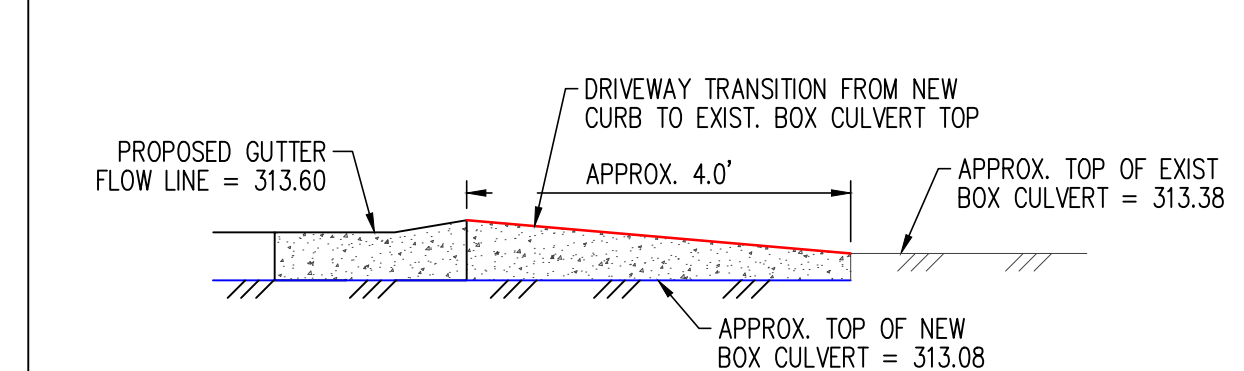
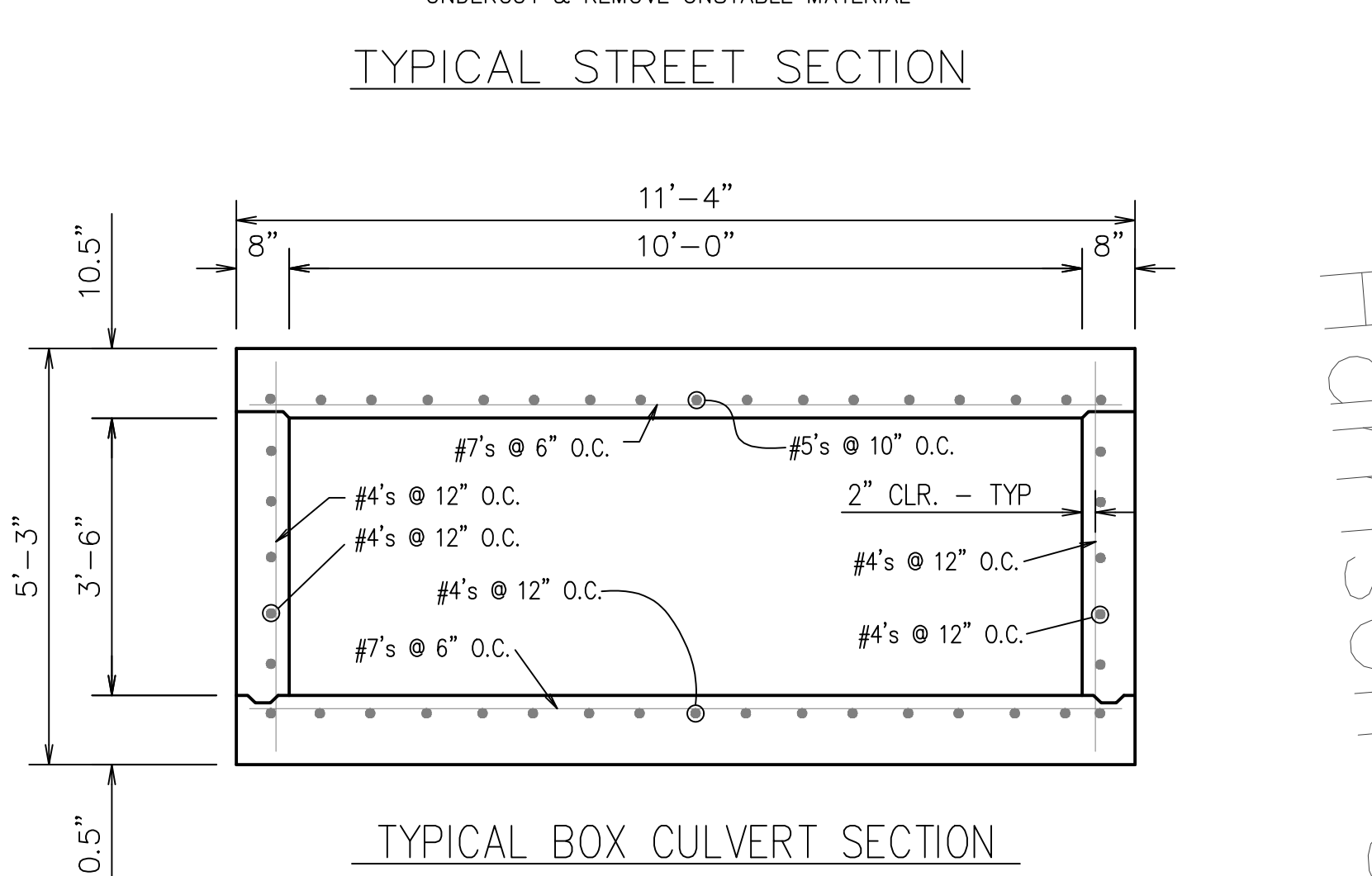
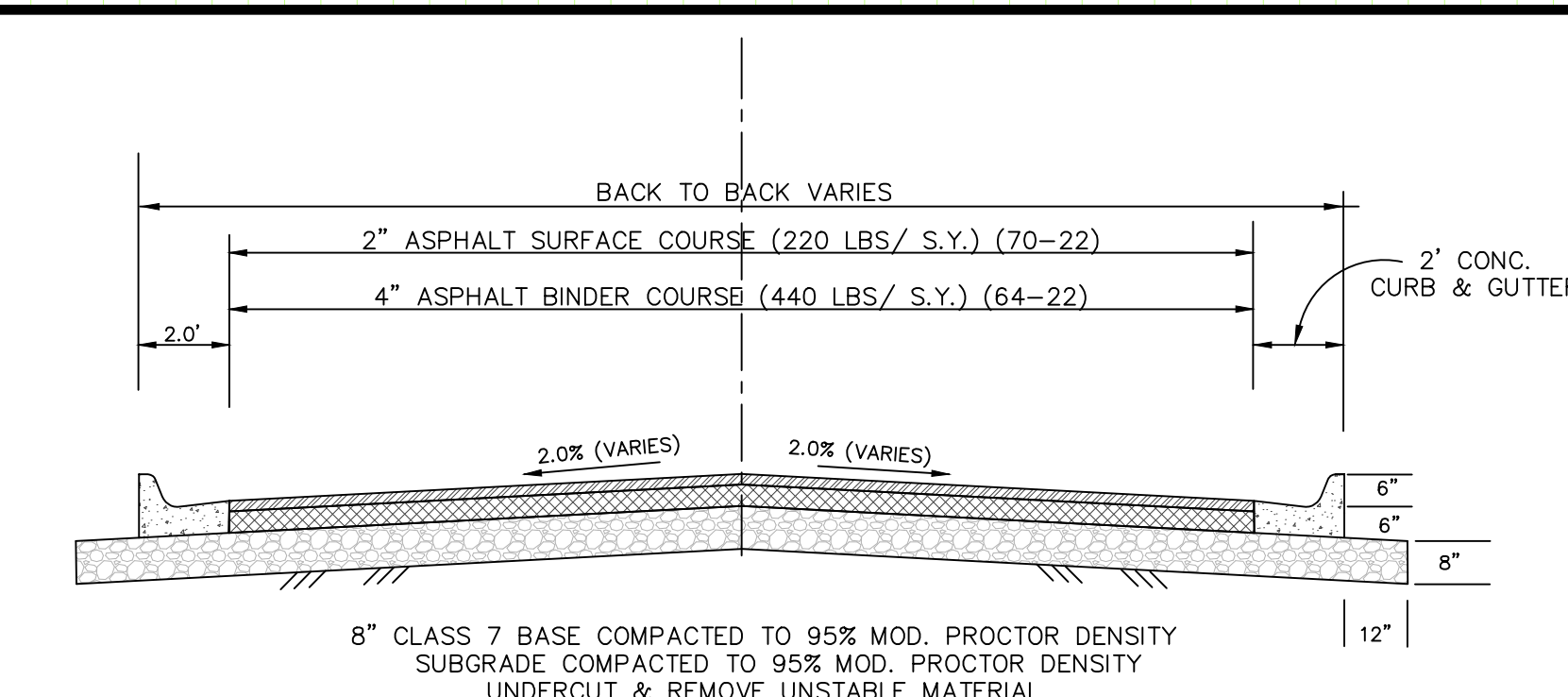
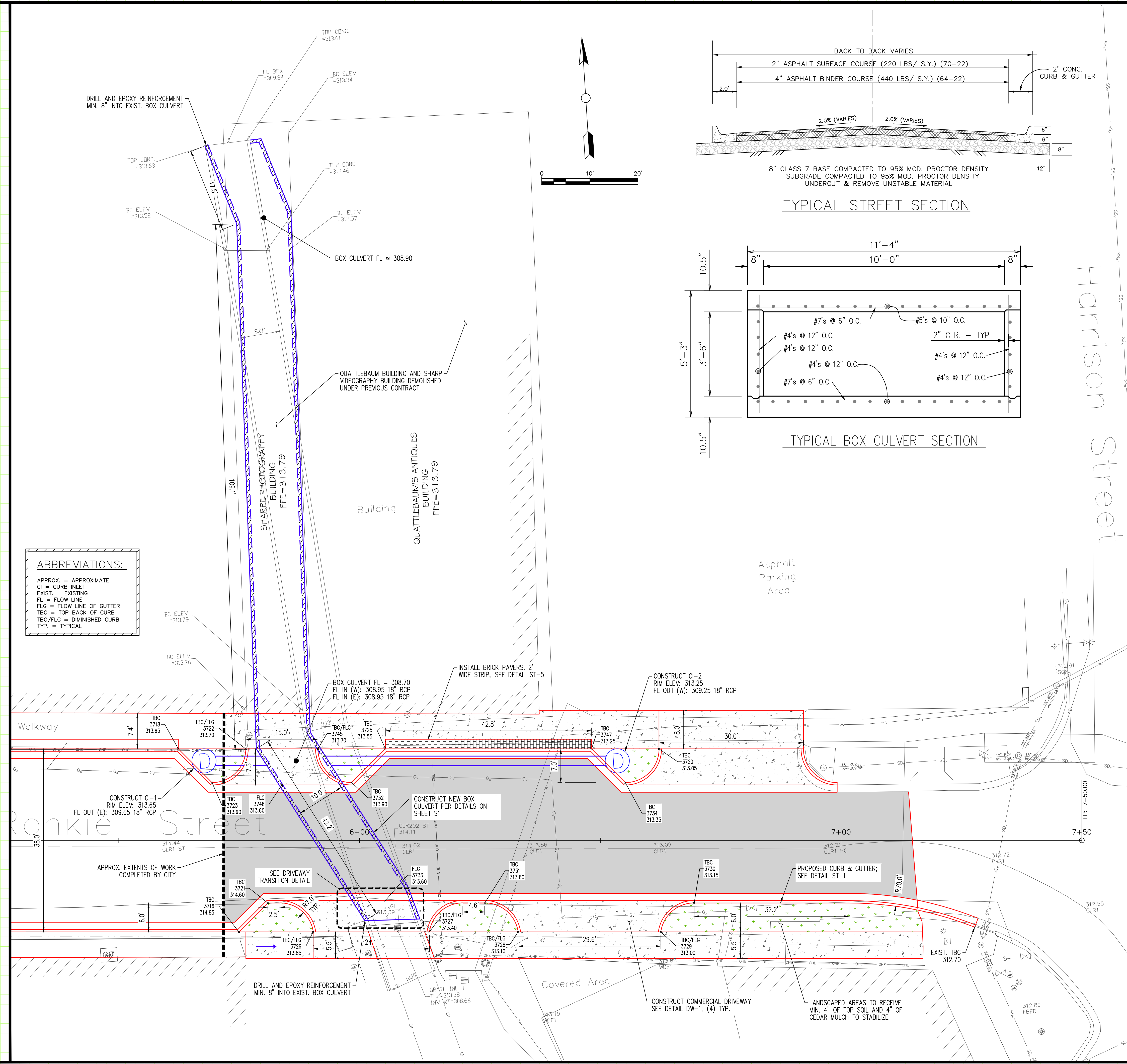

- REINFORCED CONCRETE BOX CULVERT NOTES:**
- CONCRETE SHALL BE CLASS S WITH A MINIMUM 28 DAY COMPRESSIVE STRENGTH OF 3500 PSI.
 - REINFORCING STEEL SHALL BE AASHTO M31 OR M53, GRADE 60.
 - MEMBRANE WATERPROOFING SHALL CONFORM TO THE REQUIREMENTS OF SECTION B15 OF THE ARDOT STANDARD SPECIFICATIONS FOR HIGHWAY CONSTRUCTION, CURRENT EDITION.
 - MEMBRANE WATERPROOFING SHALL BE APPLIED TO ALL CONSTRUCTION JOINTS IN THE TOP SLAB AND THE SIDEWALLS OF THE R.C. BOX CULVERT AS DIRECTED BY THE ENGINEER.
 - WEEP HOLES IN BOX CULVERT WALLS SHALL HAVE A MAXIMUM HORIZONTAL SPACING OF 10'-0" AND SHALL BE SPACED TO CLEAR ALL REINFORCING STEEL. THE DRAIN OPENING SHALL BE 4" DIAMETER AND SHALL BE PLACED 12" ABOVE THE TOP OF THE BOTTOM SLAB.
 - BOTTOM SLAB TO BE PLACED ON MINIMUM 4" OF CLASS 7 STONE OR APPROVED ALTERNATIVE.

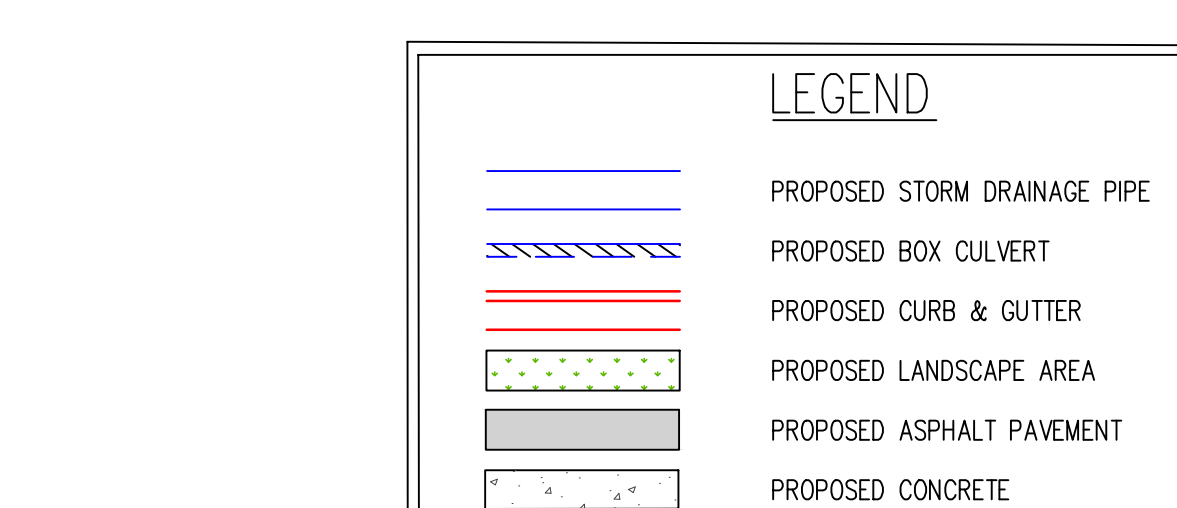

- NOTES:**
- CITY OF CONWAY STANDARD DETAILS FOR ROADWAY AND DRAINAGE CONSTRUCTION ARE LOCATED ON THE TRANSPORTATION DEPARTMENT WEB PAGE. REFERENCE THIS FOR GENERAL NOTES AND CONSTRUCTION DETAILS. HARD COPY WILL BE PROVIDED WITH PLAN SET.
 - ALL CONSTRUCTION & MATERIALS SHALL COMPLY WITH THE ARKANSAS HIGHWAY & TRANSPORTATION DEPARTMENT STANDARD SPECIFICATIONS FOR HIGHWAY CONSTRUCTION, CURRENT EDITION, UNLESS OTHERWISE NOTED.
 - NOTIFY THE TRANSPORTATION DEPARTMENT OF ANY DISCREPANCIES BETWEEN EXISTING CONDITIONS SHOWN ON THE PLANS AND WHAT IS FOUND ON-SITE.
 - NOTIFY THE TRANSPORTATION DEPARTMENT OF ANY FIELD CHANGES THAT MAY BE NECESSARY.

ABBREVIATIONS:
 APPROX. = APPROXIMATE
 CI = CURB INLET
 EXIST. = EXISTING
 FL = FLOW LINE
 FLG = FLOW LINE OF GUTTER
 TBC = TOP BACK OF CURB
 TBC/FLG = DIMINISHED CURB
 TYP. = TYPICAL